



26 North Gyle Grove, Corstorphine, Edinburgh, EH12 8JZ

Offers Around £225,000

Description

Attractive detached bungalow situated in a quiet cul-de-sac within an established residential area. The property has been well maintained but would now benefit from some upgrading. Accommodations comprises: entrance vestibule, hallway, lounge, dining room, kitchen, two double and one single bedrooms and bathroom. Gas central heating and double glazed. Lovely mature gardens to front and rear. Driveway with parking for two cars. Excellent storage. All carpets and curtains included

Viewing

Viewing Sunday 2 - 4 pm or by appointment telephone 07742302085

Features

- Excellent residential area
- Quiet cul-de-sac
- Mature gardens to front and rear
- Gas central heating
- Double glazed
- Cavity wall insulation
- Driveway with parking for two cars
- All carpets and curtains included
- Excellent storage
- Good local amenities

– Where personal legal service is a tradition –



26 North Gyle Grove, Corstorphine, Edinburgh, EH12 8JZ



Location

North Gyle Grove is a quiet cul-de-sac which lies within the established and sought after residential district of Corstorphine to the North West of Edinburgh. The property is close to excellent local amenities including a Tesco Superstore and the Gyle Shopping centre. There is a wide and varied range of retail outlets, banks and related services on St John's Road. There are good local schools in the area and the property is within the catchment area for Craigmount High School. Leisure facilities include Gogarburn and Carricknowe Golf Course and David Lloyd Leisure and Fitness Centre. From the nearby main road there are frequent bus services to the West End, Princes Street and other parts of the city. There is also a commuter rail link from South Gyle. The many offices at the Gyle and Edinburgh and Gogar Business Park are within a few minutes drive via the Maybury Junction and from the Gogar roundabout there is access to the city by-pass, M8 and M9 motorway networks and Edinburgh International Airport.

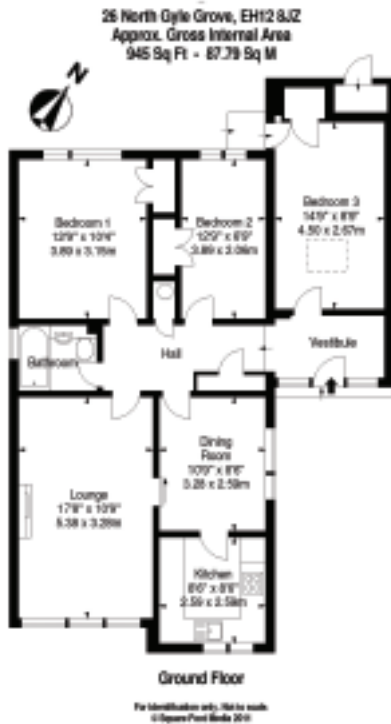

16 Queen Street Edinburgh EH2 1JW
Telephone: 0131-225 2354 Fax: 0131-220 2388
DX: ED 30 EDINBURGH-1
E-mail: michelle@lindsayduncanblack.co.uk

The above particulars are believed to be correct but are not warranted and will not form part of any contract of sale. All measurements are approximate.

